

17685R 45 MAPLEWOOD AVENUE, MAPLEWOOD #



Board of Realtors of the Oranges and Maplewood

Photo by George B. Biggs, Inc.

17685 45 MAPLEWOOD AVENUE, MAPLEWOOD #



Board of Realtors of the Oranges and Maplewood

Photo by George B. Biggs, Inc.



17685 45 Maplewood Ave., Mplwd. \$49,500 1

Bet: Parker Ave-Ent. on private Rd-
& Walton Ave

Lot 50x180x40 Lot 143, Plt 13

Col, frame, cedar rf, all removable ss & scrs, 220 VS,
lst-3-ch, lr w/fp, dr, kit, 2 porches, / 100 Amps.

1 open, 1 encl. frt porch scr'd, patio ,, brk nk.

2nd-4-4 bedrms, bath w.s.o.tub

3rd-Attic-closed stairs, floored w/48" attic fan

Bsmt-laund.

/Foundation for garage on/

HA:Gas

/Walton Rd. which can be con-/

No garage, paved drive /structured there/

L-8.6 B-17.4 '76 Tax Rate 7.31 Taxes \$1900.60. Poss:

30 days or arranged. Col on high side of Mplwd Ave

with a view. Can be shown from Mplwd Ave frt door or
private Rd ent. off Walton Rd leading to back of

ppty. No garage but area reserved back of hse for

family cars. Kit modernized. Cedar f 5 yrs old. Sun

range dble oven. Permanent filters in htg unit. Ease-

ment for rear road. Space for lst flr lav. Call direct

for all appts. Dog on premises. Jefferson GS., Mplwd Jr,

Columbia HS., Lady of Sorrows paro. Bus 31, Mplwd RR Sta

~~Subject to Errors and Omissions.~~

LR:RGS 379-5200 90013006/30013007 6-60-40 o.a.a.)

Owner: Albert P. Braun, ll & Dorothy E. Stillwell, prem

762-0165

Conv. 45 Maplewood Ave., Mplwd. 7-1-0 4 br. \$49,500

#7520--3/7/77 Under contract by Sands.

#7546--5/4/77 Contingency removed.. Selling price \$45,000

50817 45 Maplewood Ave, Mplwd. \$29,900 1
 Near Parker Ave. All cash
 Lot 50x180x40 irreg. Lot 143, Pl. 13
 Col, 45yrs, frame, comp. rf, cap ins, all scr. & s.s,
 1st-3-c.h, l.r, fp, d.r, brk.nk, kit, 2 o.p. (front scr)
 2nd-4-4 bdrms, 1 t.bath w/sh.o/tub
 Attic-trap-48" attic fan
 Bsmt-laund, g.i. & cop.w.p.
 HA: Gas, \$200 ann. cost, new gas furnace
 1-car frame det. garage, paved drive
 LB: VHB 763-5044 8/19/67-Exp. 2/18/68

Owner Harold E. & Adele V. Tracy, prem, 762-7530, Bus. East-
 ern Auto Salvage, Inc, Easton, Pa, 215-258-2925
 L 5.0, B 14.0, 1967 taxes \$866.40
 Immed. poss. Garage ent. off private rd. in rear maintained
 by neighbors. Ent. is off Walton Rd. near Mplwd. Ave. or off
 Mplwd. Ave. toward town. Easement for rear rd. Rear porch-
 lovely flagstone patio. New alum. leaders & gutters. House
 termite treated-owner has policy. Space for 1st fl. lav.
 Jefferson GS, Mplwd. Jr, Col. HS, Sorrows, Bus 31, Mplwd. RR
 SEE ADDITIONAL INFORMATION

Conv. 45 Maplewood Ave, Mplwd. 7-1-1 HA: Gas \$29,900

.....
 50817 45 Maplewood Ave, Mplwd. \$29,900 1
 ADDITIONAL INFORMATION

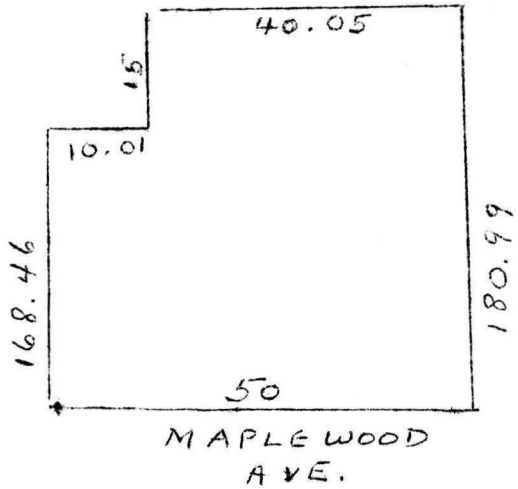

Conv. 45 Maplewood Ave, Mplwd. 7-1-1 HA: Gas \$29,900

#6093--8/23/67 Now APPROVED. No screens for d.r.

#6097--9/1/67 Under contractt by Lansu.

#6107--9/25/67 Contingency removed. Selling price \$28,500

L.B. to G.M.D. 1/24/47
45 Maplewood Avenue, Maplewood
Lot 50 x 180

\$17,500
F&C

frame Farm house

1st: l.r., d.r, c.h., mod.kit., laund., open & rear porches

2nd: 4 bedrms., 1 bath

3rd: Open

*R.E.D. - Sept. '47 - Sold to
Biford S. Anderson,
Prem for \$13,500.*

HA:Stoker

2-car detached garage

Tenant: Marshall, S.O. 2-6090, leased to May 1/47, OPA poss.

Owner: M.H. Kizer, c/o Brown & Co., S.O. 2-0036 70-30

Do not show without app't. Gas range not included. House in good condition.

1946 Assess: L.V. \$1,300 Taxes \$231.84
B.V. 4,300
\$5,600

9/47-Owner to W.P. - Sold

45 Maplewood Avenue, Maplewood 7-1-2 HA:Stoker \$17,500

Real Estate Directory December 1945

45 Maplewood Avenue, Maplewood

Sold to May H. Kizer for 13M